

PORTABLE GROOVER M

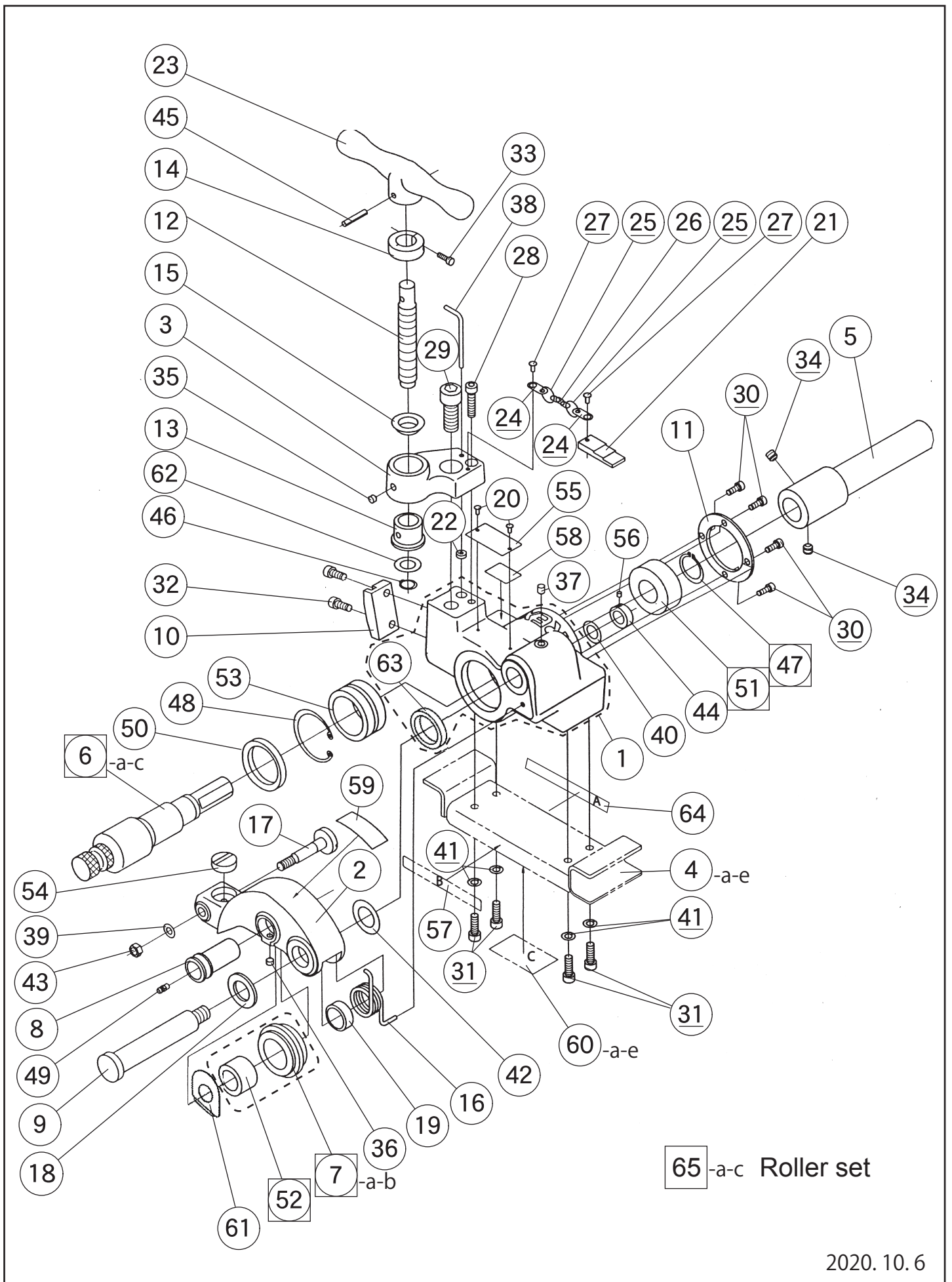

2020.10.6

REX

PORTABLE GROOVER M

2020/10/6

No.	Part No.	Description	Qty	Remarks
1	RM01	Main body	1	to be supplied with No.63 RM37 Support ring
2	RM02	Roller holder	1	
3	RM03	Bushing plate	1	
4-a	RMA1	Mount base R1	1	For N50A, R/P50A, NP/NR50A (Option)
4-b	RMA2	Mount base R2	1	For N/S80A, NP80A (Option)
4-c	RMA5	Mount base R3	1	For N100A (Option)
4-d	RMA3	Mount base E1	1	For #300 (Option)
4-e	RMA4	Mount base E2	1	For 300 Compact (Option)
5	RM05	Connecting shaft	1	
6-a	RM24	Spindle 1"	1	Option
6-b	RM26	Spindle 1.1/4-1.1/2"	1	Option
6-c	RM06	Spindle 2-6"	1	
7-a	RM25	Upper roller 1-1.1/2"	1	Option:to be supplied with No.52
7-b	RM07	Upper roller 2-6"	1	to be supplied with No. 52 RM32 Needle bearing
8	RM08	Roller shaft	1	
9	RM35	Hinge bolt B	1	
10	RM10	Guide plate	1	
11	RM11	Bearing plate	1	
12	RM12	Feed screw	1	
13	RM13	Screw bushing	1	
14	RM14	Adjusting nut	1	
15	RM15	Bushing cap	1	
16	RM16	Return spring	1	
17	RM17	Guide bolt	1	
18	RM18	Washer	1	
19	RM19	Collar	1	
20	WN34	Rivet (#4x5)	2	
21	RM21	Depth gauge 1 - 6"	1	
22	RM22	Rubber bushing	1	
23	RM23	Handle	1	
24	4202	Chain locking washer	2	
25	U576	Ring	2	
26	U577-3	Chain (3 line)	1	
27	W4A3	Oval head machine screw (M4x10)	2	
28	W084	Socket head cap screw (M8x35)	1	
29	W016	Socket head cap screw (M16x40)	1	
30	W062	Socket head cap screw (M6x16)	4	
31	W083	Socket head cap screw (M8x25)	4	
32	W082	Socket head cap screw (M8x20)	2	
33	W054	Socket head cap screw (M5x15)	1	
34	W702	Hex socket set screw (M10x10)	2	
35	W682	Hex socket set screw (M8x10)	1	
36	W662	Hex socket set screw (M6x8)	1	
37	W78B	Hex socket set screw (M8x12)	1	
38	ZB24	Hex wrench (4mm)	1	
39	WG10	Spring washer (10mm)	1	
40	W188	Flat washer 16 (17x30x3mm)	1	
41	WG08	Spring washer (8 mm)	4	
42	RM33	Thrust washer (AS2542)	1	
43	WC10	Hexagon nut (M10)	1	
44	RM36	Lock nut	1	
45	WL68	Roll pin (6x35)	1	
46	RM32	Retaining ring (16mm)	1	
47	WW30	Retaining ring (30mm)	1	
48	WWA6	Retaining ring (62mm)	1	
49	J009	Grease nipple	1	
50	RM28	Oil seal (AE2775EO)	1	
51	RM27	Ball bearing (5206ZZ)	1	
52	RM32	Needle bearing (TR253825)	1	it is also to be supplied with No.7 Upper roller 2-6
53	RM31	Needle bearing (TR486230)	1	
54	4074	Pin	1	
55	-	Name plate (English)	1	not for sale
56	W990	Hex socket set screw (SBCP5-8)	1	
57	7A77	Base seal B (English)	1	
58	7A79	Handle seal (English)	1	
59	7A78	Warning seal (English)	1	
60-a	7A72	Base seal C - R1 (English)	1	for No. 341554 (N50A, R/P50A, NP/NR50A)
60-b	7A73	Base seal C - R2 (English)	1	for No. 341555 (N/S80A, NP80A)
60-c	7A71	Base seal C - R3 (English)	1	for No. 341559 (N100A)
60-d	7A74	Base seal C - E1 (English)	1	for No. 341556 (#300)
60-e	7A75	Base seal C - E2 (English)	1	for No. 341557 (#300 Compact)
61	RM34	Thrust washer	1	
62	W187	Flat washer 16 (17x28x2.5mm)	1	
63	RM37	Support ring	1	
64	7A76	Base seal A (English)	1	
65-a	341551	Roller set 1"	1 set	Set of No.6-a, 7-a, 47, 51, 52
65-b	341552	Roller set 1.1/4-1.1/2"	1 set	Set of No.6-b, 7-a, 47, 51, 52
65-c	341558	Roller set 2-6"	1 set	Set of No.6-c, 7-b, 47, 51, 52