

No. 10 LINK CUTTER

OPERATION MANUAL

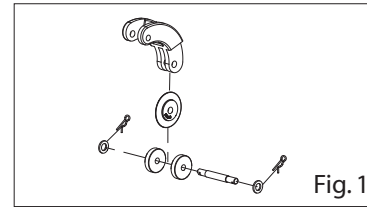
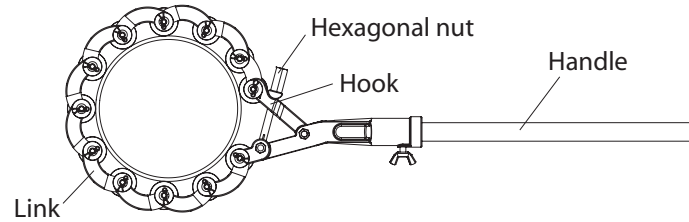

Number of Link Cutter Blades

Steel pipe	Size	80A	100A	125A	150A	200A	250A
	Maximum thickness(mm)		4.2	4.5	4.5	5	5.8
Ductile pipe	Size	75A	100A		150A	200A	250A
	Maximum thickness(mm)	7.5	7.5		7.5	7.5	7.5
Links		3	4	5	6	8	10
Connecting links		1	1	1	1	1	1
Blades		5	6	7	8	10	12

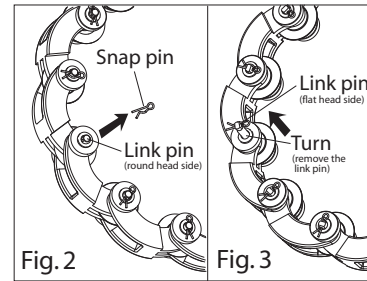

Fig. 2

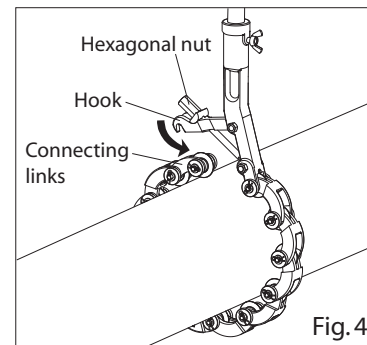

Fig. 3

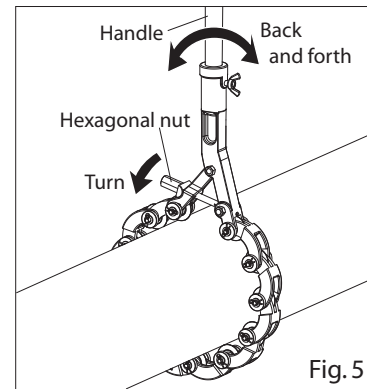

Fig. 4

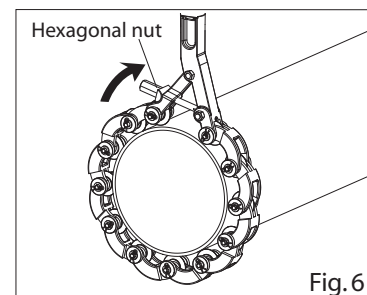

Fig. 5

Removing and Attaching a Link

Refer to the Table above to select the number of links required based on the nominal size of the pipe. Add or remove links accordingly. (Fig. 1)

● Removing a link:

- Remove the snap pin from the round head side of the link pin. (Fig. 2)
- Use a monkey wrench or similar to turn the flat head side of the link pin, and remove the pin so as to release the roller, washer and blade wheel. (Fig. 3)

● Attaching a link:

As shown in the diagram, align the roller, washer and blade wheel in relation to the link, and attach a link in the reverse order to the above.

Attaching the Link Cutter

Wrap the link around the pipe where you want to cut it, place the hook over the end of the connecting link, and turn the hexagonal nut with the ratchet handle to tighten the link around the pipe. (Fig. 4)

● Warning

- Make sure the hexagonal nut is turned fully back before wrapping the link around the pipe.
- Attach the link cutter so that the blades are at right angles to the pipe.

Cutting

Move the handle back and forth at least 60° (for 250A pipe) or 100° (for ductile pipe size 75 & steel pipe size 80A), turn the hexagonal nut with the ratchet handle and the blades will start cutting into the pipe. For each movement back and forth of the handle, turn the ratchet wrench approximately 1/8 of a turn (45°). (Fig. 5)

Dismantling the Link Cutter

Loosen the hexagonal nut with the ratchet wrench, unscrew the hexagonal nut by hand as far as it will go, and then lift the hook off the connecting link. (Fig. 6)

REX REX INDUSTRIES CO., LTD.

Overseas Sales Section & Factory :

1-9-3, Hishiyahigashi, Higashi Osaka 578-0948, Japan
Tel.: +81 - (0)72 - 961 - 9820 Fax.: +81 - (0)72 - 961 - 9878

URL <https://www.rexind.co.jp>

8Z700-E1
No.10 Link cutter
0901R 0000

●Specifications, colour, etc. may be changed without prior notification.
●This operation manual has been printed using soy ink and recycled paper.

No. 2 LINK CUTTER

OPERATION MANUAL

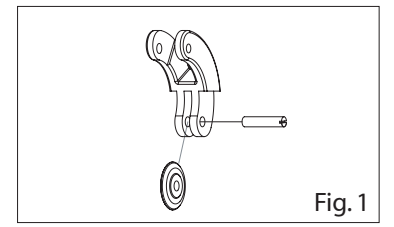
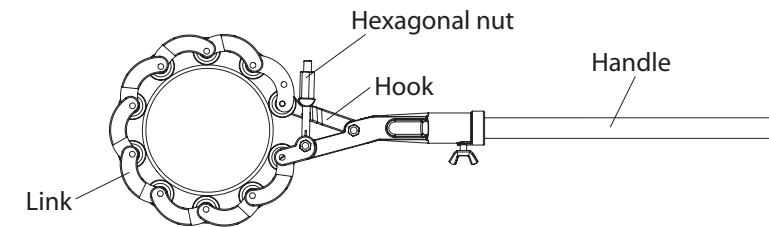

Number of Link Cutter Blades

Size	75A	100A	150A	150A
Maximum thickness (mm)	12			
Links	3	4	6	8
Connecting links	1	1	1	1
Blades	5	6	8	10

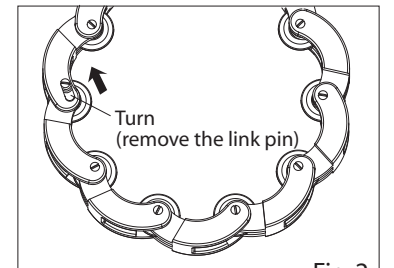

Fig. 2

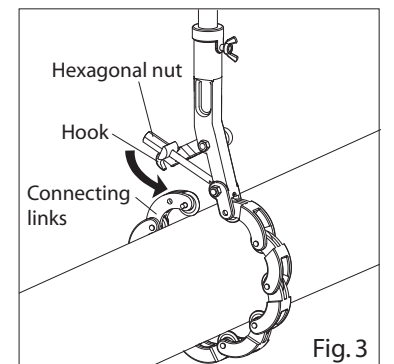

Fig. 3

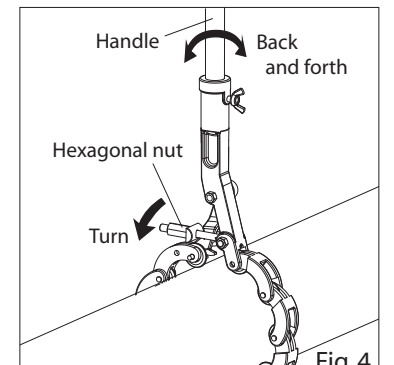

Fig. 4

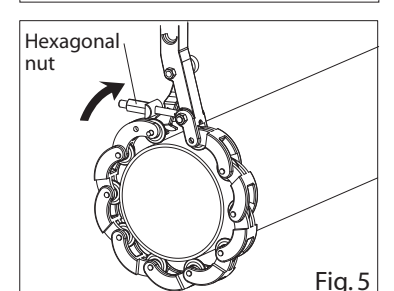

Fig. 5

Removing and Attaching a Link

Refer to the Table above to select the number of links required based on the nominal size of the pipe. Add or remove links accordingly. (Fig. 1)

● Removing a link:

Use a flathead screwdriver to unscrew the link pin and pull it out. (Fig. 2)

● Attaching a link:

Attach a link in the reverse order to the above.

Attaching the Link Cutter

Wrap the link around the pipe where you want to cut it, place the hook over the end of the connecting link, and turn the hexagonal nut with the ratchet handle to tighten the link around the pipe. (Fig. 3)

● Warning

- Make sure the hexagonal nut is turned fully back before wrapping the link around the pipe.
- Attach the link cutter so that the blades are at right angles to the pipe.

Cutting

Move the handle back and forth at least 60° (for 200A pipe) or 100° (for 80A pipe), turn the hexagonal nut with the ratchet handle and the blades will start cutting into the pipe. For each movement back and forth of the handle, turn the ratchet wrench approximately 1/8 of a turn (45°). (Fig. 4)

Dismantling the Link Cutter

Loosen the hexagonal nut with the ratchet wrench, unscrew the hexagonal nut by hand as far as it will go, and then lift the hook off the connecting link. (Fig. 5)

REX REX INDUSTRIES CO., LTD.

Overseas Sales Section & Factory :

1-9-3, Hishiyahigashi, Higashi-Osaka 578-0948 Japan
Tel.: +81 - (0)72 - 961 - 9820 Fax.: +81 - (0)72 - 961 - 9878

URL <https://www.rexind.co.jp>

8Z690-E1
No.2 Link cutter
0901R 0000

●Specifications, colour, etc. may be changed without prior notification.
●This operation manual has been printed using soy ink and recycled paper.