

# CORDLESS FLARE

RF20S

1/4" - 3/4"

Attractive new lightweight design! Ease of use greatly improved!



### Standard Accessories

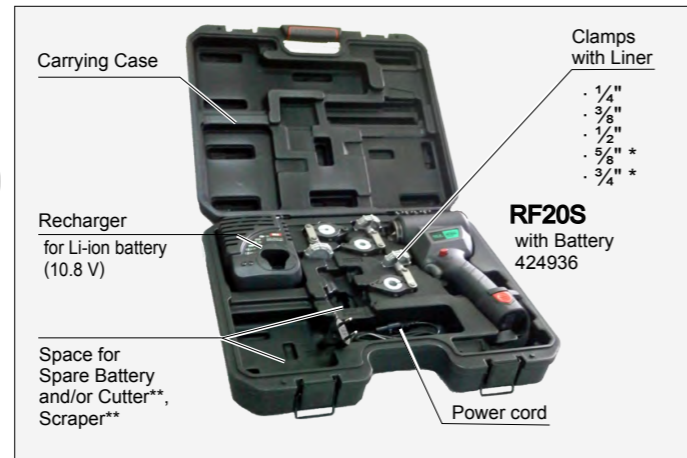

### Specifications

Applicable Tube : Copper Tubes (O-type, OL-type) JIS H3300  
 Applicable Tube Size : 1/4", 3/8", 1/2", 5/8", 3/4" \*  
 Flare Type : Supports Class 2 refrigerant (Supports R-410A)  
 Dimensions (LxWxH) mm : 122 x 67.5 x 224 (122 x 67.5 x 274 with battery)  
 Time for flaring : About 5 seconds  
 Flaring method : Revolving eccentric cone under stable pressure  
 Revolution speed : 280 rpm  
 Motor : DC motor  
 Battery : 10.8 V Li-ion (424982)

Code No.	Model	Voltage (V)	Weight (kg)	
			Body	with Battery
424901	Cordless Flare RF20S	100	1.22	1.41
424936	Cordless Flare RF20S	220		

### Optional Accessories

Code No.	Model (Article)
424982	10.8 V Li-ion Battery
424961	Recharger 100 V
424981	Recharger 220 V
424950	Clamp without Liner for RF20S
424850	Liner 1/4" (6.35 mm)
424852	Liner 3/8" (9.52 mm)
424853	Liner 1/2" (12.70 mm)
424854	Liner 5/8" (15.88 mm)
424855	Liner 3/4" (19.05 mm)
424980	Flanging Tool Set
471991	Scraper
471992	Blade for Scraper 10 pcs Set

### Battery Specifications

Capacity (mAh) : 1,500  
 Charging time (min) : 60 (approx)  
 Charges/Discharges : 500 times  
 Dimensions (mm) : L60 x W54 x H85

Code No.	Type	Output Voltage (V)	Weight (g)
424982	Li-ion Battery	10.8	185

### Recharger Specifications

Charging time (min) : 60 (approx)  
 Dimensions (mm) : L146 x W109 x H61

Code No.	Battery Type	Input Power Supply	Weight (g)
424981	Li-ion Battery 10.8 V	AC220 V (50/60 Hz) 60 VA	335

### Eccentric Cone

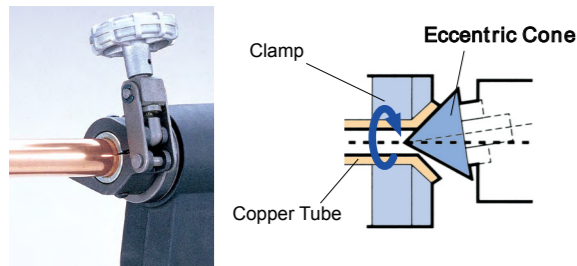

The eccentric cone moves forward with a rotary motion to gradually push and expand the inner diameter of the copper tube. The forward movement of the cone is then stopped by the clutch, which activates at a predetermined pressure. The flared surface of the copper tube is given a clean finish by the cone's rotary motion.

### One-Action Mechanism

The clamped position of the copper tube is fixed using a stopper, eliminating unevenness in the flaring of the copper tube.

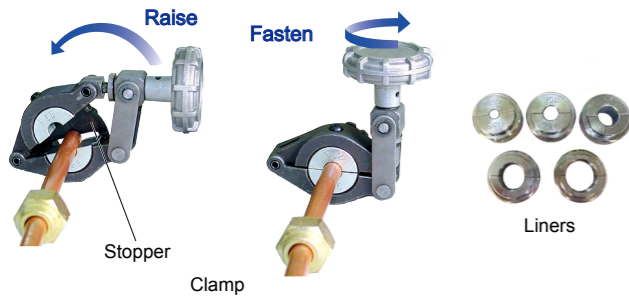

### Option Flanging tool set changes RF20S to RT20S

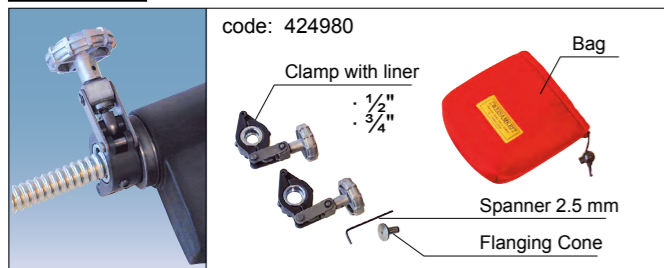

# CORDLESS FLANGE / REAMERS

RT20S

1/2" - 3/4"

Auto-flanging in 5 seconds! (1/2" - 3/4" stainless flexible tube)



### Specifications

Applicable tube : M-13 (1/2") (16.7 - 16.8 mm), M-13 (3/4") (20.0 mm)  
 Number of flanges : 2 or 3 ridges  
 Time for flanging : About 5 seconds  
 Flanging method : Revolving eccentric cone under stable pressure  
 Revolution speed : 280 rpm  
 Motor : DC motor  
 Battery : 10.8 V Li-ion (424982)  
 Standard accessories : Recharger (424981), Clamps with Liner (1/2", 3/4"), Spanner (2.5 mm), Carrying Case

Code No.	Model	Voltage (V)	Weight (kg)	
			Body	Clamp
424977	Cordless Flange RT20S	220	1.2	0.35

### Optional Accessories

Code No.	Model
424975	Clamp without Liner for RT20S
424777	Liner 1/2" (16.8 mm)
424778	Liner 3/4" (20.0 mm)

### STAINLESS FLEXIBLE TUBE

M-13, M-15

Made of stainless steel SUS316L: strong and corrosion resistant.



Code No.	Model	Contents
170713	M-13	10 m roll / package
170715	M-15	10 m roll / package

### FLEXIBLE TUBE CUTTER

8A - 32A



- Plastic and polyurethane rollers enable smooth cutting with less twisting of external vinyl coat.
- Cuts stainless steel flexible tube precisely with fewer burrs and dents.
- The body is light and smooth textured, made of aluminium die-cast.
- Spare blade included as standard.

Code No.	Model	Applicable sizes (A)	Weight (g)
1703F2	Flexible Tube Cutter	20	210
1703F3		25	320
1703F4		32	320
1703F5		CLICK 25	340
424200	Cutter Wheel for 1703F2	8 - 20	23
1703F7	Cutter Wheel for 1703F3/4/5	8 - 25, 25 - 32	30
1702FS	Stripper	8 - 32	80

### MULTI REAMER

Φ8 - Φ54

40 blades, high durability!

Reaming both inside and outside of pipe / tube.  
 Applicable pipe: Stainless steel pipe, Copper tube, Aluminium pipe, Steel pipe, and Plastic pipe.

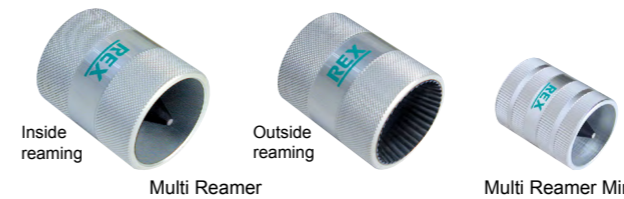

Code No.	Model	Capacity	Weight (g)
382250	Multi Reamer	Φ10 - Φ54	390
382255	Multi Reamer Mini	Φ8 - Φ30	210